

Executes equipment

NACA.-02/05

On/Off floating action electric damper actuator

[Description]

This is a small electric damper actuator. Normally be used for variable air flow control device of cooling, heating, ventilation or the ventilation of an industrial process. It may also work with the other devices to control temperature, humidity or pressure.

[Features]

The electric damper actuator NACA.-05 series combines a "gear box", "holder" and "electric control circuit" to be an actuator. It has the following features.

- ON-OFF, 3 points floating control.
- This series has 2~5Nm torque, adapts to small damper.
- Lock to the rotate bar.
- Round: ϕ 6~16mm, Square: 5~12mm.
- One SPDT contact, can set position switch.
- CW or CCW motor directional control.
- Save energy when stop. Runs at low-noise.
- Manual operation and setting the rotate angle.
- Show damper position on its cover.



[Specification]

Model	Torque	Damper size	Action time	Power supply	Power consumption	Capacity	Weight
NACA1-02 (S1)	2 Nm	0.5 m ²	60~90 Second	24VAC/ DC	Running: 2.0W, stop: 2.0W	4.0 VA	0.5Kg
NACA2-02 (S1)	2 Nm	0.5 m ²	60~90 Second	220VAC	Running: 2.0W, stop: 2.0W	12.0 VA	0.5Kg
NACA1-05 (S1)	5 Nm	1 m ²	70~100 Second	24VAC/ DC	Running: 2.0W, stop: 2.0W	4.0 VA	0.5Kg
NACA2-05 (S1)	5 Nm	1 m ²	70~100 Second	220VAC	Running: 2.0W, stop: 2.0W	12.0 VA	0.5Kg

Note: (S1) means the model has a assist contact switch.

Power Frequency	: 50~60HZ
Control signal	: ON- OFF, 3 points of floating types (FLOATING)
Assists Contact	: One SPDT contact for model with (S)
Contact Capacity	: 3A (1.5A) ,220 VAC
Rotation Angle	: 90° (can set up range 5~85°, each squares 5°)
Rotator Size	: Rotund: ϕ 6~16mm, square: 5~12mm.
Appearance	: ABS plastic (light blue)
Protect grade	: IP54 with PG11 cable connector
Operation Temperature	: -20℃~ 50℃
Operation Humidity	: 5~95 % RH
Noise	: 40dB
Certificate	: Accord with CE Certification

[Wiring]

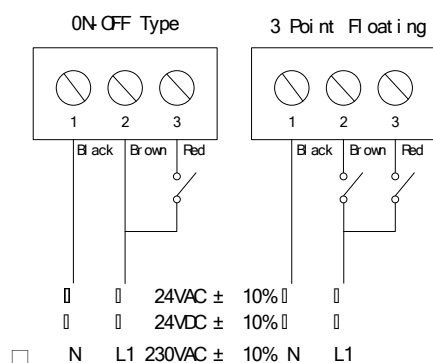

Turn CW/CCW on cover to change rotate direction.

CW –Clockwise rotation
CCW – counter clockwise rotation

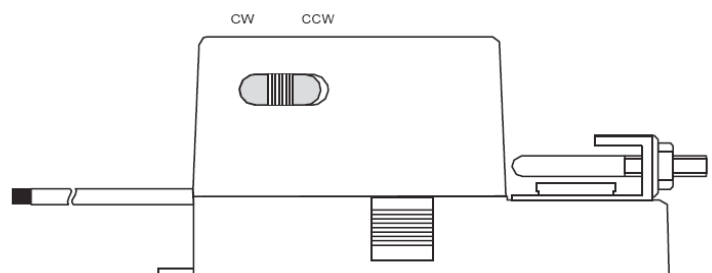

[Assists Relay] model with S1

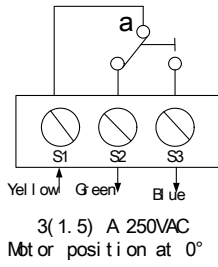

Assists position switch adjustment

Turn the auxiliary switch to its setting position if necessary

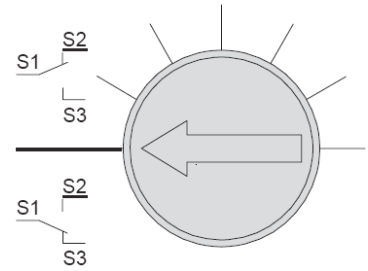

[Feedback Potentiometer] model with P2

Angle stopper:

- Adjust the screw stopper.
- 1. Release both stopping screws
- 2. Move to proper position
- 3. Locks tight both screws

【Installation】

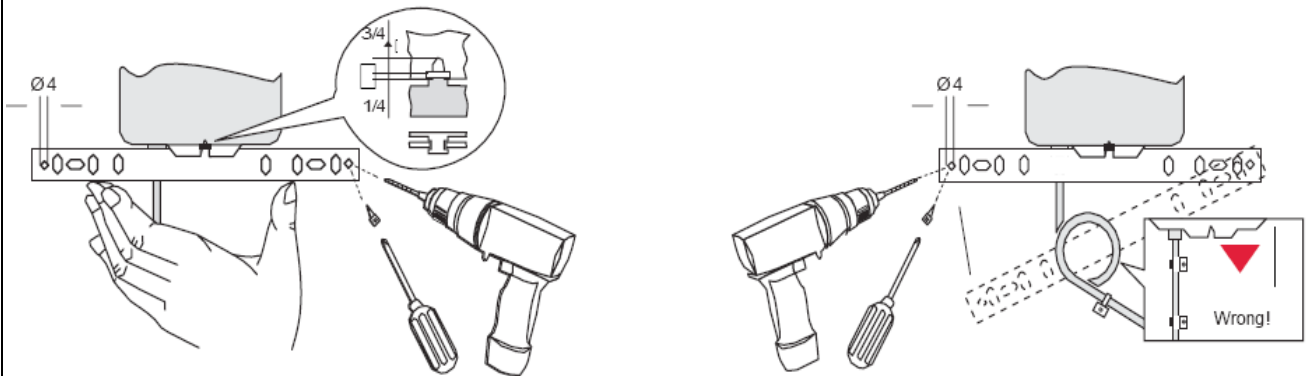

[Dimension] unit: mm

